

MITSUBOSHI

INDUSTRIAL POWER TRANSMISSION PRODUCTS CONVEYOR BELTS ENGINEERING PLASTIC



To give attentive consideration to both productivity and nature.

All sizes of Mitsubishi Conventional V-belts respectively meet the dimensional requirements as stated in ARPM/RMA IP-20.

SUPER VS (Variable Speed Belt)

Changes in speed can be accurately, smoothly and quietly transmitted from low to high speed.
 High precision and transmission efficiency as well as excellent durability.
 Almost no elongation. Excellent oil, heat and lateral pressure resistance.
 Specially for high performance and high quality transmission systems.

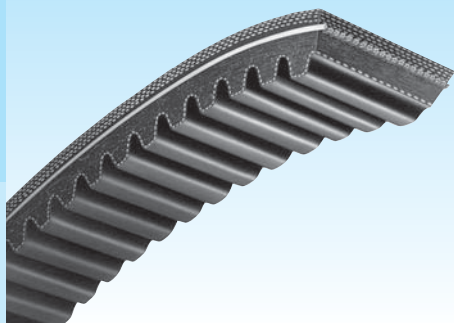

Cross-Sectional Dimensions

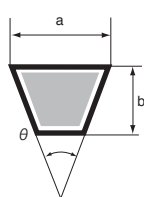

a(mm)	b(mm)	θ°
30	10	24
37	12	24
12	5	24
16	6	24
22	8	24
10	5	24
12	6	24
16	8	24
20	10	24
20	12	24

Product Code

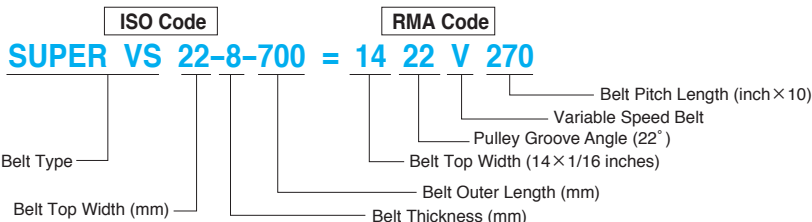

Standard Belt Sizes

ISO Code	RMA Code	ISO Code	RMA Code	ISO Code	RMA Code	ISO Code	ISO Code	ISO Code
30-10-668	1922V256	37-12-855	2322V329	22-8-615	1422V235	10-5-450*	16-8-600*	20-10-1600*
30-10-723	1922V277	37-12-945	2322V364	22-8-625	1422V240	10-5-475*	16-8-625*	20-10-1650*
30-10-733	1922V282	37-12-995	2322V384	22-8-648	1422V250	10-5-500*	16-8-650*	20-10-1700*
30-10-773	1922V298	37-12-1030	2322V396	22-8-700	1422V270	10-5-525*	16-8-675*	20-10-1750*
30-10-783	1922V302	37-12-1090	2322V421	22-8-755	1422V290	10-5-550*	16-8-700*	20-10-1800*
30-10-813	1922V313	37-12-1120	2322V434	22-8-780	1422V300	10-5-575*	16-8-725*	20-10-1850*
30-10-813	1922V314	37-12-1140	2322V441	22-8-855	1422V330	10-5-600*	16-8-750*	20-10-1900*
30-10-838	1922V321	37-12-1190	2322V461	22-8-880	1422V340	10-5-625*	16-8-775*	20-10-1950*
30-10-863	1922V332	37-12-1240	2322V481	22-8-930	1422V360	10-5-650*	16-8-800*	20-10-2000*
30-10-878	1922V338	37-12-1255	2322V486	22-8-1030	1422V400	10-5-675*	16-8-825*	20-12-750*
30-10-943	1922V363	37-12-1345	2322V521	22-8-1085	1422V420	10-5-700*	16-8-850*	20-12-800*
30-10-988	1922V381	37-12-1395	2322V541	22-8-1135	1422V440	10-5-725*	16-8-875*	20-12-850*
30-10-998	1922V386	37-12-1545	2322V601	22-8-1185	1422V460	10-5-750*	16-8-900*	20-12-900*
30-10-1043	1922V403	37-12-1595	2322V621	22-8-1200	1422V466	12-6-500*	16-8-925*	20-12-950*
30-10-1078	1922V417	37-12-1700	2322V661	22-8-1210	1422V470	12-6-525*	16-8-950*	20-12-1000*
30-10-1098	1922V426	37-12-1750	2322V681	22-8-1235	1422V480	12-6-550*	16-8-975*	20-12-1050*
30-10-1143	1922V443	37-12-1800	2322V701	22-8-1390	1422V540	12-6-575*	16-8-1000*	20-12-1100*
30-10-1173	1922V454	37-12-1850	2322V721	22-8-1540	1422V600	12-6-600*	20-10-750*	20-12-1150*
30-10-1188	1922V460	37-12-2055	2322V801	22-8-1690	1422V660	12-6-625*	20-10-800*	20-12-1200*
30-10-1248	1922V484	37-12-2120	2322V826	22-8-1845	1422V720	12-6-650*	20-10-850*	20-12-1250*
30-10-1353	1922V526	37-12-2170	2322V846	22-8-1995	1422V780	12-6-675*	20-10-900*	20-12-1300*
30-10-1398	1922V544	37-12-2270	2322V886			12-6-700*	20-10-950*	20-12-1350*
30-10-1553	1922V604	37-12-2360	2322V921			12-6-725*	20-10-1000*	20-12-1400*
30-10-1618	1922V630	12-5-451	7.522V173			12-6-750*	20-10-1050*	20-12-1450*
30-10-1663	1922V646	12-5-501	7.522V193			12-6-775*	20-10-1100*	20-12-1500*
30-10-1708	1922V666	12-5-551	7.522V212			12-6-800*	20-10-1150*	20-12-1550*
30-10-1758	1922V686	12-5-571	7.522V220			12-6-825*	20-10-1200*	20-12-1600*
30-10-1813	1922V706	16-6-513	1022V196			12-6-850*	20-10-1250*	20-12-1650*
30-10-1848	1922V721	16-6-548	1022V210			12-6-875*	20-10-1300*	20-12-1700*
30-10-1863	1922V726	16-6-573	1022V220			12-6-900*	20-10-1350*	20-12-1750*
30-10-1928	1922V751	16-6-578	1022V223			12-6-925*	20-10-1400*	20-12-1800*
30-10-1938	1922V756	16-6-628	1022V247			12-6-950*	20-10-1450*	20-12-1850*
30-10-2068	1922V806					12-6-975*	20-10-1500*	20-12-1900*
30-10-2168	1922V846					12-6-1000*	20-10-1550*	20-12-1950*

Note 1) * = only in ISO Code.

Note 2) Please contact us for sizes beyond the standard size.